



AIRE GUARDIAN® AG5000

Modular Mobile Containment Cart

INSTRUCTION MANUAL

US Patent Pending

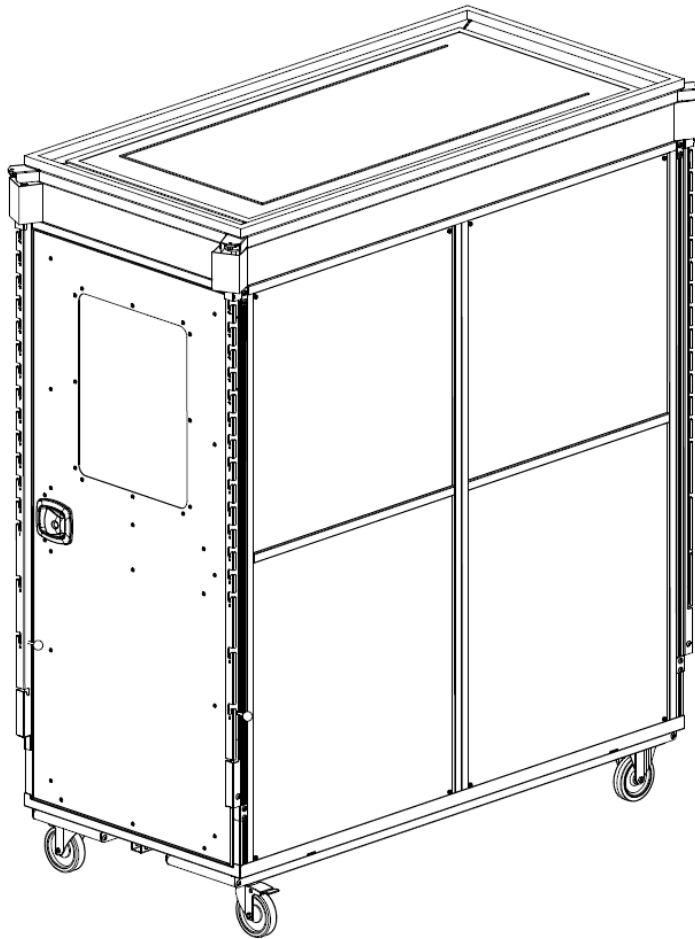

Abatement Technologies

Abatement Technologies, Inc.
Georgia, USA
+1 800 634 9091

Abatement Technologies Limited
Ontario, Canada
+1 905 871 4720

www.abatement.com

READ AND SAVE THESE INSTRUCTIONS!

Note:

1. **Read and understand all operating instructions before using the ABATEMENT TECHNOLOGIES® AIRE GUARDIAN® AG5000 Cart.**
 2. **Save this manual for future reference.**
-

This manual provides important information on the features and usage of the AG5000 Modular Mobile Containment Cart. These instructions must be carefully followed in order to assemble and use the components safely and correctly. If you have any questions regarding this system, please call Abatement Technologies at +1 800 634 9091 (US) or +1 905 871 4720 (Canada) for assistance or to request a digital copy of this manual.

Table of Contents

Important Safety Instructions.....	1
General Information.....	2
Feature Identification.....	3
Key Components	5
Optional Components	6
Assembly Instructions	7
Securing the Panels.....	7
Assembly Steps	8
Operating Instructions	11
Basic Operation	11
Suggested Operating Procedure.....	14
Disassembling the Cart	15
Care of the Cart.....	16
Aire Guardian® AG5000 Specifications	17

IMPORTANT SAFETY INSTRUCTIONS

⚠ **Important:** Read the following warnings and instructions before assembling or using the ABATEMENT TECHNOLOGY® Carts or Portable Air Scrubbers.

⚠ **Warning:** Failure to follow all instructions may result in serious personal injury or death!

⚠ **Warning:** This mobile containment cart is made primarily of metal. Metal conducts electricity. Use extreme caution when using near electrical circuits, equipment, or other electrical conductors!

⚠ **Warning:** Do not use around exposed energized lines or equipment. Power to the lines in the area of work must be turned off and protected from being turned on with a lockout-tagout.

⚠ **Warning:** Do not use this cart near sparks, open flames, or other possible sources of ignition.

⚠ **Warning:** Lock both casters of the AIRE GUARDIAN® AG5000 Cart before assembly or use. Do not enter cart without both casters being locked and stable!

⚠ **Warning:** Pinch hazard! Keep fingers clear of upper frame. Do not use hands or fingers to unlock swivel casters or personal injuries such as severe pinching or cuts could result. Use work shoe to lock and unlock casters.

Two able bodied adults are required to assemble the AG5000 Cart. **Do not attempt to assemble a cart alone.**

Personnel responsible for assembly are urged to wear the proper personal protective equipment (PPE) and follow safe work practices in accordance with federal, state, provincial, local and employer regulations. Abatement Technologies cannot recommend the type of PPE required as that will need to be determined by safety/risk assessment personnel based on various risk factors.

Do not leave cart unattended without locking both casters.

Both casters must be locked before entering the AG5000 Cart.

The AG5000 Cart is for use by one person only. Maximum load capacity is 900 pounds distributed.

Use extreme caution when entering or exiting the AG5000 Cart.

Never move the cart while someone is inside! Always check to be certain no one is inside the unit before moving it.

Use only on level, dry surfaces. Do not use on slippery surfaces.

Do not put anything under the base or wheels of the AG5000 Cart.

Do not use in front of doors that could unexpectedly be opened into the AIRE GUARDIAN® AG5000 Cart.

Only use where allowed under federal, provincial, state, local, and facility regulations.

Read and follow all ladder manufacturer's warnings if using a ladder inside of the AG5000 Cart.

Inspect for damage before each use. Be sure all parts are present and in working order. Abatement Technologies strongly urges all users of the AG5000 Cart to follow the most recent guidelines and/or standards published by the Occupational Safety and Health Administration, Environmental Protection Agency, and all other federal, state, provincial, local and employer regulations. In addition, the proper personal protective equipment should be used at all times.

Before using, learn and understand your facility's Infection Control Risk Assessment (ICRA). Follow all Centers for Disease Control (CDC) and Association for Professionals in Infection Control and Epidemiology (APIC) recommendations.

GENERAL INFORMATION

The ABATEMENT TECHNOLOGIES® AIRE GUARDIAN® AG5000 Cart is a modular mobile containment unit designed to be used as a mobile containment area for airborne contaminant control while doing operations and maintenance activities in hospitals and other facilities. The modular construction reduces the cart's footprint to 32.5" W x 66.25" D x 20" H for storage and transport while providing the same benefits as a hard-side containment unit.

The AG5000 Cart can capture and contain particulate during ceiling access work on ceiling heights up to 10'-4". The unit will accommodate up to an 8-foot A-frame step ladder (not included). To ensure safe operation of the ladder, please read all instructions as well as all danger, caution, and instruction labels affixed to the ladder.

If particulate needs to be contained when performing maintenance or minor construction on walls, an optional side access panel (sold separately) can be installed in place of one or two of the side panels.

This unit should also be used in conjunction with an air scrubber in order to meet ICRA requirements where required. An ABATEMENT TECHNOLOGIES® PRED750 or PAS750 Portable Air Scrubber (sold separately) attaches behind the unit and is externally ducted to the unit's port. Alternatively, a canister HEPA vacuum (sold separately) can be used in place of the scrubber. Either the air scrubber or HEPA vacuum is attached using a Caddy Cart (P/N: AGCADDY, sold separately).

This manual provides instructions on how to use the features of the AG5000 Cart, however, the procedure and/or order of operations in which it is used should be determined by the healthcare facility's ICRA plan. **Any procedural information contained within this manual is to be taken as a suggestion only to help the user understand some of the design intent of the unit.**

FEATURE IDENTIFICATION

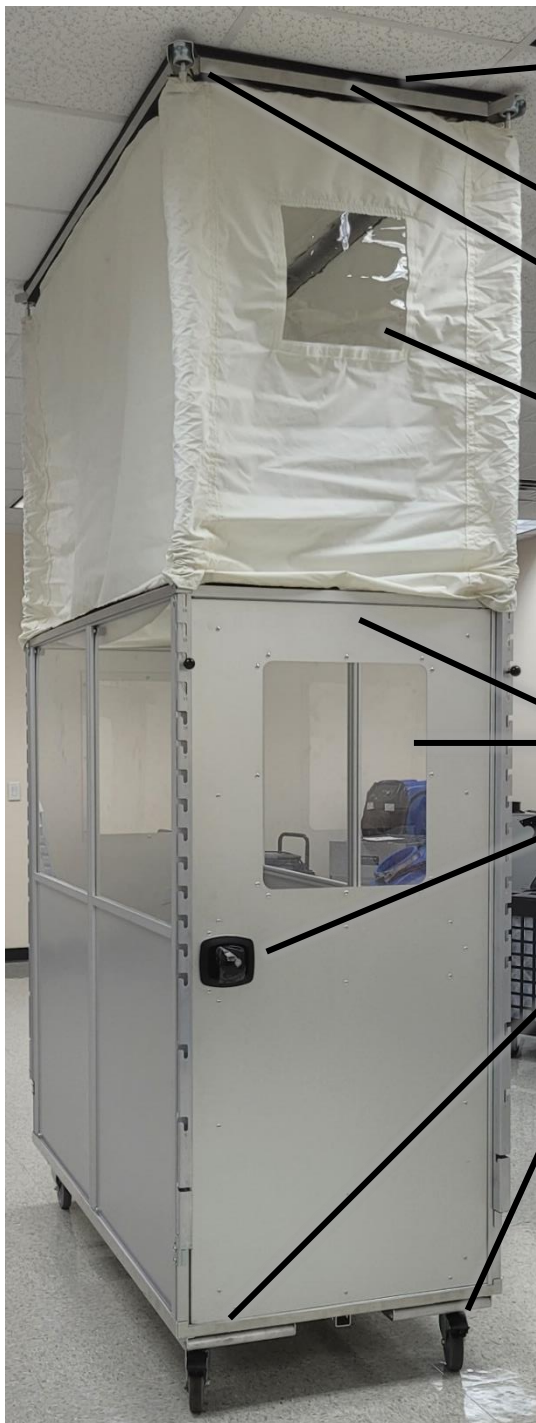

- A. Foam gasket. The $\frac{3}{4}$ " thick foam gasket provides a seal when the header is raised to the ceiling.
- B. Upper frame. The upper frame provides an even seal to the ceiling.
- C. Spring plunger. The plungers attach the upper frame to the poles and accommodate small height adjustments.
- D. 12" x 12" upper windows and pass-through. Two clear upper windows allow visibility into and out of the fabric enclosure. The windows are attached via hook and loop on three sides, enabling it to be opened and act as pass-throughs for items such as pipe or conduit.
- E. Door. Door opening of 63" H x 27" W.
- F. Clear windows: The clear windows allow for visibility into the unit.
- G. Lockable recessed handle. The lockable door helps protect tools and equipment within the mobile containment cart when not in use.
- H. Lift handles. This unit has two (2) lift handles in the front and two (2) lift handles in the rear.
- I. Casters. This unit has two (2) locking casters in the front and two (2) swivel casters in the rear.

Note: To reduce the risk being locked out of the AG5000 Cart, Abatement Technologies suggests making a copy of the key and storing the master in a secure place.

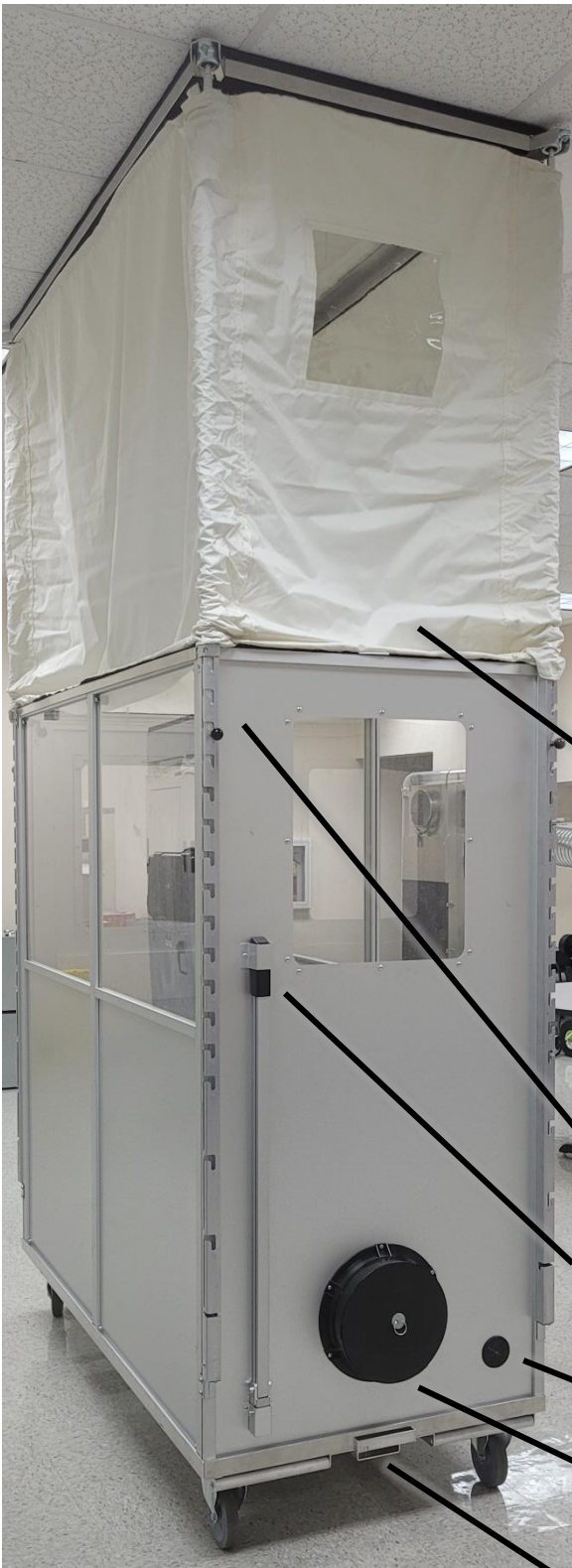

- J. Top Cover. The Top Cover closes the opening in the upper frame to provide full containment during transport and during usage before ceiling tiles are removed (PN:AG5000TOP-FR).
- K. Fabric enclosure. The fabric enclosure provides a flexible barrier that can accommodate the raising and lowering of the header. This enclosure is constrained by the telescoping members, which keeps it from encroaching into the work space under negative pressure. It is removable and washable (PN: AG5000ENC-FR).
- L. Raising/lower mechanism. Four telescoping poles with 2.5" groove increments in the posts.
- M. Pull handle. Handle which can be attached to the front of the cart for ease of maneuvering the collapsed cart.
- N. Power cord pass through and HEPA vacuum hose attachment.
- O. Intake/exhaust port with foam plug, 10" (25.4 cm) diameter. Collar for ducting to an external PAS750 or PRED750.
- P. AGCADDY hitch: Attachment location for the AGCADDY (not included).

KEY COMPONENTS

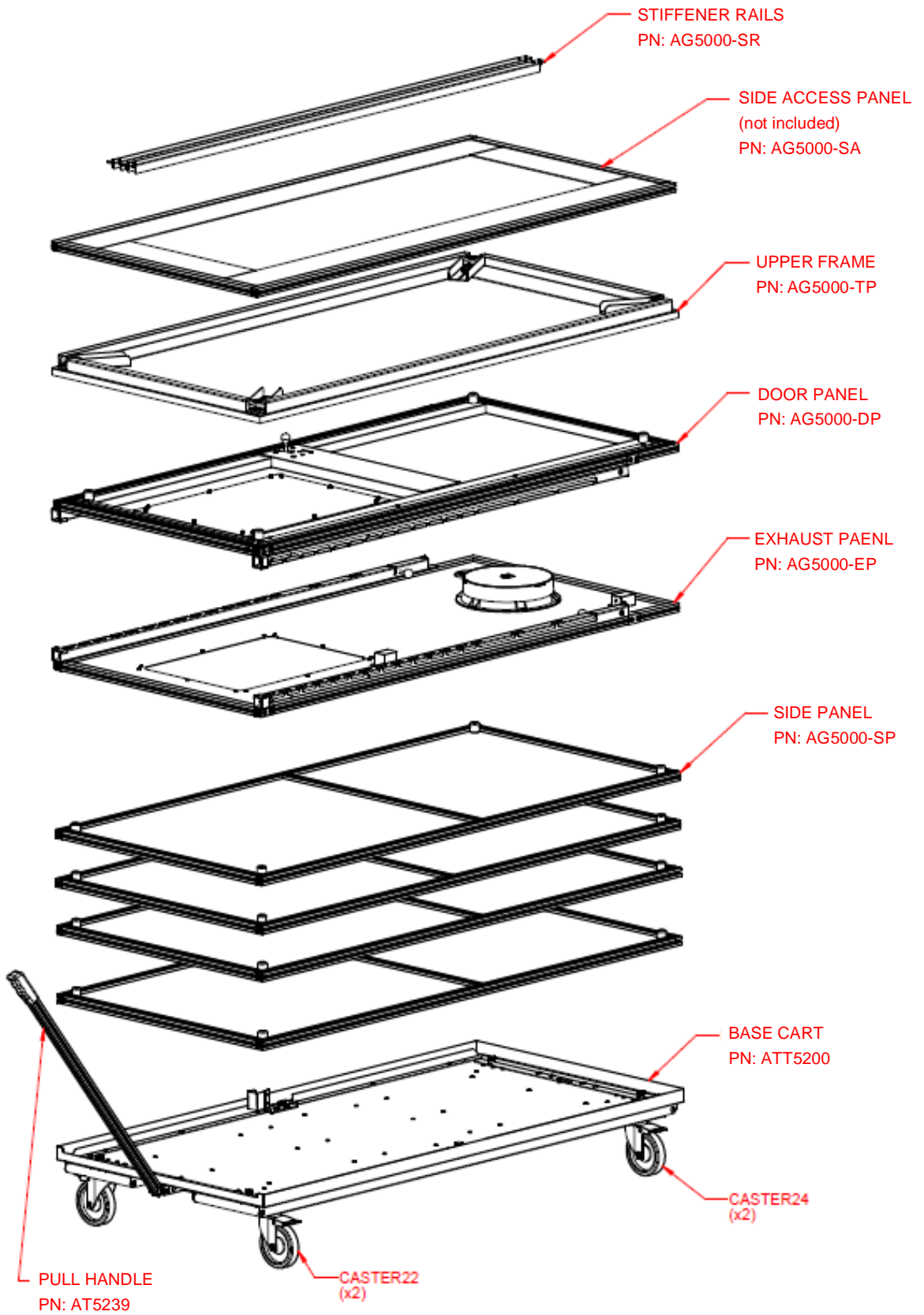



The front of the Base Cart has the channel for the pull handle, two (2) lift handles, and two (2) locking casters.



The rear of the Base Cart has the AGCADDY hitch, two (2) lift handles, and two (2) swivel casters.

OPTIONAL COMPONENTS

Side Access



The Side Access Panel can replace any of the Side Panels to provide access to walls. Two Side Access Panels can be installed side by side for a larger opening. **Note:** If using two Side Access Panels, the frames will obstruct the center of the opening.

Part Numbers:

AG5000-SA	Side Access Panel
-----------	-------------------

Pressure Monitor

If a room air filtration unit is being used to create and maintain a negative/positive pressure condition, the pressure differential between the negative/positive inside the cart and the environment outside the cart should be monitored with a calibrated instrument as per OSHA/CDC requirements. The ABATEMENT TECHNOLOGIES® Portable Pressure Monitor (PPM) or Room Pressure Monitor (RPM) are recommended to ensure that requirements are being met.

A mount for the RPM-RT pressure monitors is included with the unit. A Universal Pressure Monitor Mount (not included) can be purchased to mount the PPM3-S.

Part Numbers:

PPM3-S	Portable Pressure Monitor
RPM-RT1	Room Pressure Monitor
AGSHIELD-HWPMUK	Universal Pressure Monitor Mount

ASSEMBLY INSTRUCTIONS

SECURING THE PANELS

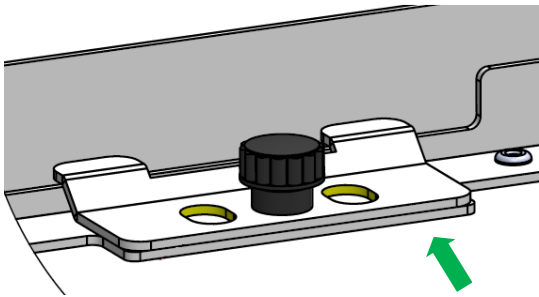

Panels are secured at the bottom by Locking Channels. The Locking Channels insert into the channel of the aluminum extrusions and are held in place by thumbscrews.

Warning: Fall Risk! Ensure the Locking Channel is fully inserted into the aluminum extrusion(s) and the thumbscrew is tightened.

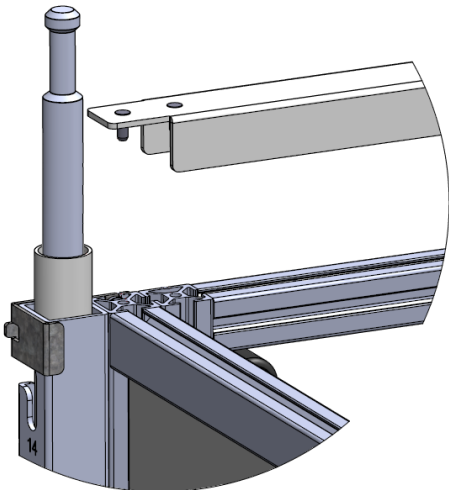

Panels are secured at the top by the Stiffener Rails held in place by hook and loop strips and pins.

ASSEMBLY STEPS

Note: Two (2) able bodied adults are required to perform installation.

Note: Any Side Panel may be replaced by an optional Side Access Panel. **Always install the Side Access Panel with the hook and loop strips upward and the flanges outward.**

1. Lock both casters by pressing the pedals on the casters down with your work shoe.
2. Unpack all the components from the Base Cart. Inspect components for damage.
3. Loosen the thumbscrews on the Locking Channels and retract the Locking Channels towards the center of the Base Cart.
4. With the bumpers facing inward, insert the Exhaust Panel into the channel on the rear of the Base Cart. Support the Exhaust Panel through Step 7.

Warning: Fall Risk! Panel is not secure. Do not leave panel unattended.

5. Slide the Locking Channel into the lower channel of the Exhaust Panel and tighten the thumbscrews.
6. With the bumpers facing inward, insert a Side Panel or Side Access Panel into the channel next to the Exhaust Panel.
7. Align the hook and loop strips and pins to place a Stiffener Rail on top of the Side Panel and the Exhaust Panel.

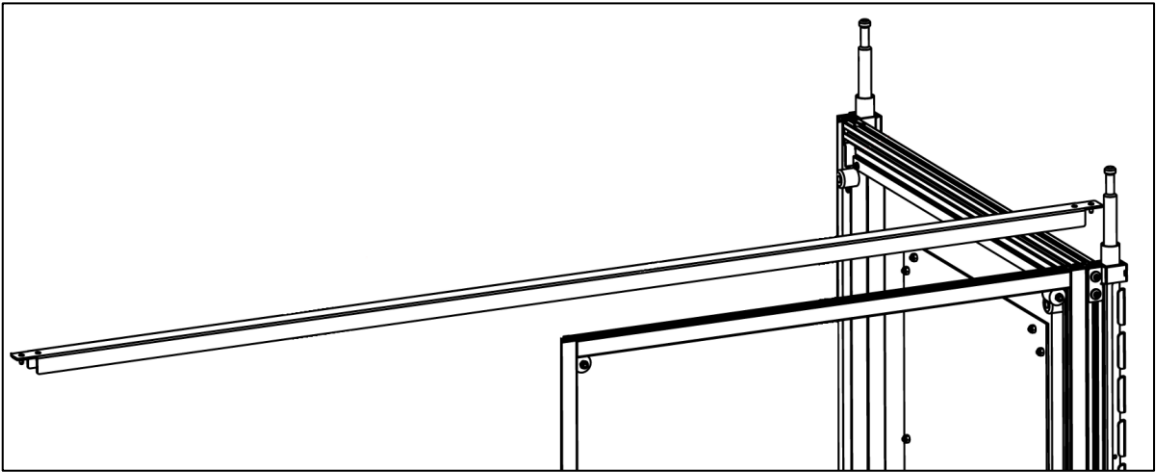

8. With the bumpers facing inward, insert the second Side Panel or Side Access Panel under the Stiffener Rail.
9. Secure the Side Panels with the Locking Channel.
10. Repeat steps 6 through 9 to add the remaining Side Panels and secure with the Locking Channel and the Stiffener Rail.

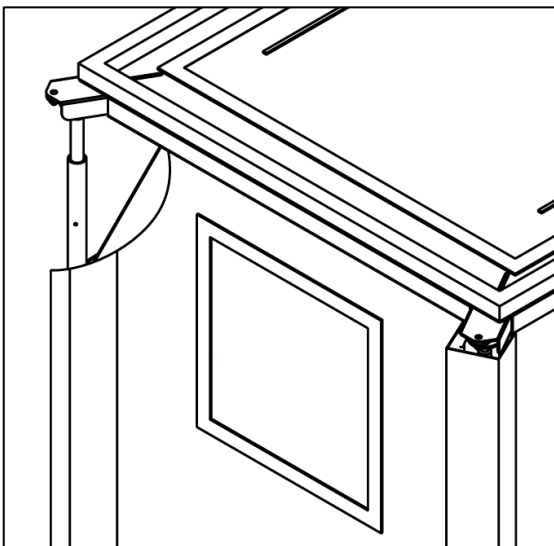

11. With the bumpers facing inwards, insert the Door Panel under the Stiffener Rails.
12. Secure the Door Panel with the Locking Channel.
13. Raise the four (4) Corner Posts to the setup "S" position.
14. Slide the Fabric Enclosure over the Corner Posts. The envelope sleeves for the poles are located on the **outside** of the Fabric Enclosure. The windows are at the top of the enclosure.

15. Attach the Top Cover to the Upper Frame with the hook and loop strips.



16. Loosen the thumbscrews to extend the pole extensions of the Upper Frame and secure in the maximum outward position.

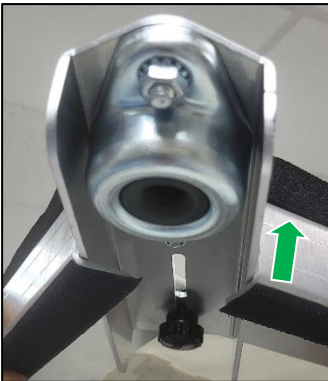

17. Place the Upper Frame on top of the unit with the “Door” indicator on the Top Cover next to the Door Panel.

18. At each extension, apply constant, downward pressure to attach the extension to the pole plunger.

19. Attach the hook and loop strips on the Fabric Enclosure to the Upper Frame, Stiffener Rails, and panels.

20. If creating a pressure differential, attach the caddy (P/N: AGCADDY, not included) per instructions.

21. Setup the scrubber or HEPA vacuum (not included) on the caddy.

- a. To create negative pressure with the scrubber, remove the foam plug from the exhaust collar, duct from the collar to the inlet, and secure with two clamps (not included).

Note: To duct to the PAS750 inlet, install a MAN-PAS600 (not included) on the PAS750 unit.

- b. To create negative pressure with the HEPA vacuum, insert the hose from the canister through the pass through.

- c. To create positive pressure, remove the foam plug from the exhaust collar, duct from the collar to the outlet, and secure with two clamps (not included).

22. Inspect assembly and reduce any air gaps.

Pressure Monitor Mount Installation

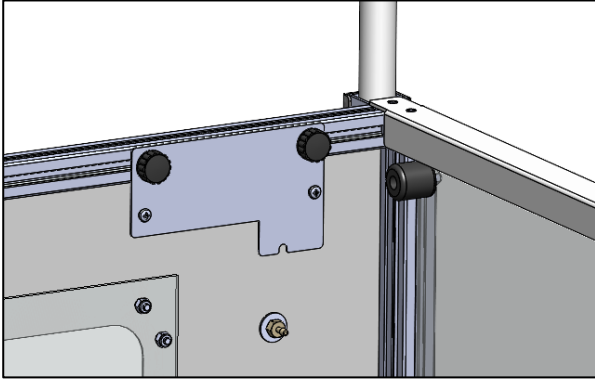

The included RPM-RT monitor mount is installed inside of the AG5000 unit.

Connect the tubing from the reference (COM) port on the monitor to the port on the Exhaust panel.

Universal Pressure Mount

The Universal Pressure Mount can attach either a PPM3-S or RPM-RT monitor to the outside of an AG5000 unit.

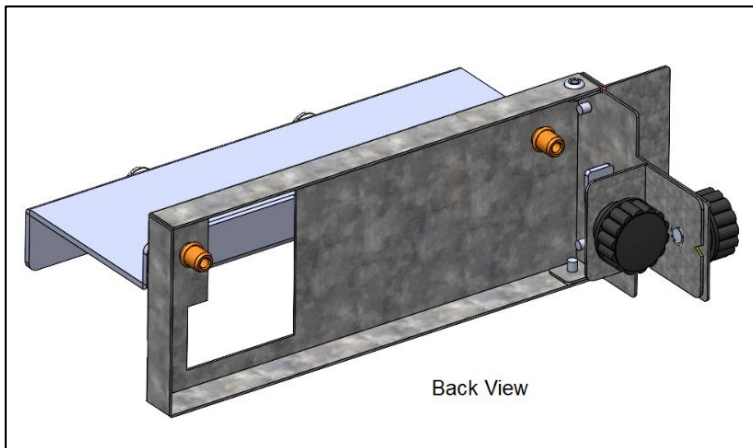
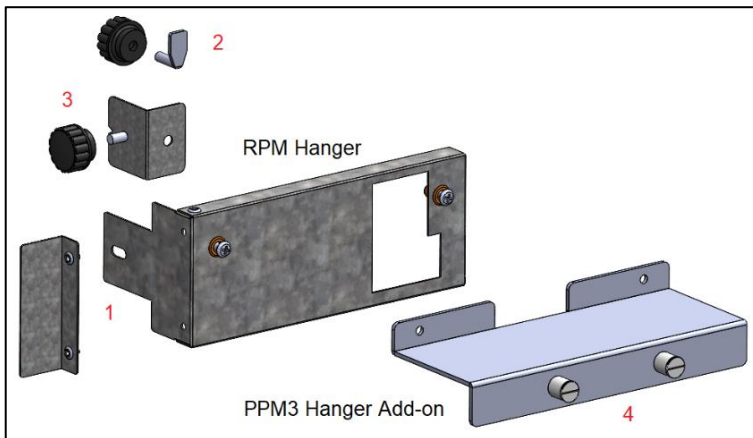

1. From the outside of the cart, insert the tab of the RPM Hanger (Item 1) through two side panels at the desired height.
2. From the inside of the cart, insert the slot screw (Item. 2) into the vertical extrusion to the left of the hanger tab.
3. Use a thumbscrew to secure the bracket (Item 3) onto the slot screw.
4. Use a thumbscrew to secure the pem of the bracket (Item 3) through the hanger tab (Item 1).
5. Use the two front screws to install the RPM monitor or PPM3 adapter.
6. Connect the tubing from the Room port of the pressure monitor to the port on the Exhaust Panel.

OPERATING INSTRUCTIONS

BASIC OPERATION

Locking the casters



To lock the casters, push down on the pedal with work shoe.

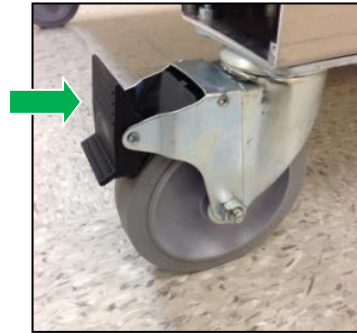

To unlock the casters, push the pedal towards the wheel with work shoe.

⚠ Warning: Pinch hazard! Do not use hands or fingers to unlock swivel casters or personal injuries such as severe pinching or cuts could result. Use work shoe to lock and unlock casters.

Transporting and positioning the AG5000 Cart underneath ceiling tiles

Transport the ABATEMENT TECHNOLOGIES® AIRE GUARDIAN® AG5000 Cart in the fully collapsed position.

⚠ Warning: Watch out for devices and fixtures installed in the ceiling and on the wall while transporting the AG5000 Cart. Colliding with any devices or fixtures can cause damage to the object it hits as well as damage the mobile containment unit.



Position the mobile containment unit in the approximate location where ceiling access is required.

Alternate raising each of the four extension posts up to three (3) notches at a time until the header is within a few inches of the ceiling. Ensure that the unit can still be moved without crashing into any objects.

After raising the header close to the ceiling, fine tune the positioning. Raise the header until it seals against the ceiling. Do not over extend the header such that the ceiling grid is damaged. Make sure that the adjustable knobs of the extension rods are resting in the bottom of the notches.

Lock both casters before entering the unit.

Narrow doorways

With the Upper Frame attached, the unit is 34.25" wide. The unit width can be reduced to 32" without removing the Upper Frame from the top of the unit by retracting the pole extensions.

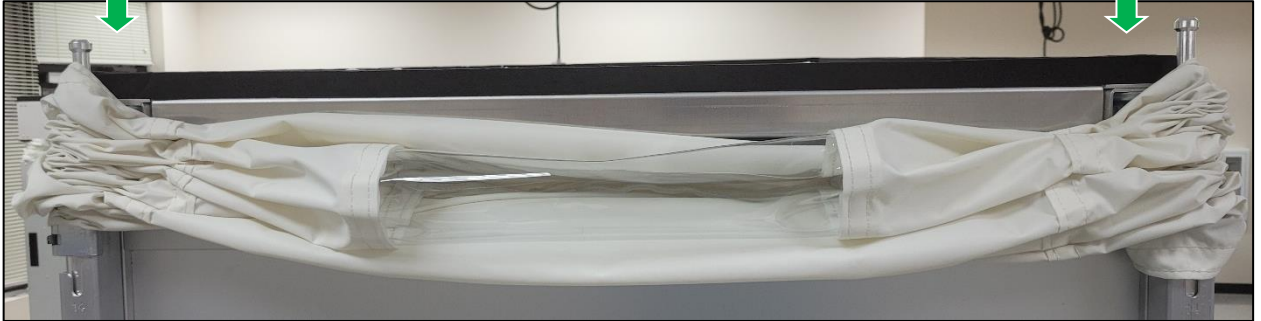

At each extension, apply steady, upward pressure to detach the Upper Frame from the pole plunger. Loosen the thumbscrew and retract the extension.

When through the doorway, extend the extension and lock it in place with the thumbscrew. At each extension, apply steady, downward pressure to attach the Upper Frame to the pole plunger.

Opening and closing the Top Cover



The Top Cover has a zipper down each long side and is secured by hook and loop on the short side near the exhaust.

Unzip the zippers on each side and detach the hook and loop on the short side near the exhaust to open the Top Cover.

Roll up the Top Cover and place it in the cove in the header.

Using the pass-throughs



Two 12" x 12" windows located in the Fabric Enclosure also act as a pass-through for conduit or other materials that need to be fed in from the outside of the mobile containment unit. Each is secured by hook and loop strips along the top and side edges and opens from the inside.



Additionally, located by the exhaust there is a pass-through for power cords or a HEPA vacuum hose.

Optional Side Access Panel



The Side Access Panel has two zippers around three sides of the panel.

Unzip the zippers to open the cover.

Roll up the cover and secure it with the two sets of hook and loop strips on the fourth side.

The Side Access Panel has four flanges to connect the cart to the wall. The flanges connect at the corners for storage.

Disconnect a flange and seal it to the wall.

Note: Select a tape appropriate for the wall material so it does not damage the wall when removed.

SUGGESTED OPERATING PROCEDURE

The following procedure is a general guideline that provides an order of operations intended to contain particulate within the ABATEMENT TECHNOLOGIES® AIRE GUARDIAN® AG5000 Cart. Review your healthcare facility's ICRA plan and use this cart accordingly.

Setup

1. Ensure the unit is decontaminated before each use, secure the ladder, and test the air scrubber (if applicable) to ensure that it is working properly and that the filters do not need to be changed.
2. Seal the unit completely before moving the unit throughout the healthcare facility.
 - a. Make sure the Top Cover is in place, zipped up, and that the hook is engaged to the loop in all places.
 - b. Make sure the Fabric Enclosure is installed properly and that the pass-through windows are closed.
 - c. Make sure the door to the unit is closed.
 - d. Make sure the Side Access Panel is zipped up (if applicable).
 - e. If a scrubber has not been attached to the unit, ensure the foam plug is in place in the exhaust port.

Ceiling Access

1. Position the unit in the approximate location under the ceiling tiles that will be accessed being careful to avoid any contact with signs or devices mounted on the walls or ceiling.
2. Alternate raising each of the four extension posts up to three (3) notches at a time. Adjust the cart position if necessary. Raise the header until the top of the unit fits snugly against the ceiling. Do not over extend the header such that the ceiling grid is damaged. Make sure that the adjustable knobs of the extension rods are resting in the bottom of the notches.
3. Lock both casters by pressing the pedals on the casters down with your work shoe.
4. Supply power to the scrubber, turn the unit on, and adjust the variable speed control to the desired speed. Open the door and enter the unit. Be sure to close the door before beginning any work inside.
5. Ensure the ladder is properly setup and secured according to the manufacturer's instructions.
6. Open the Top Cover by using the two zippers along the two long sides. Roll up the Top Cover and store it in the cove in the Upper Frame.
7. Remove the ceiling tile.
8. When finished with the ceiling work, replace the ceiling tile and close the Top Cover by using the two zippers along the two long sides.

Side Access

1. Position the unit next to the wall that will be accessed being careful to avoid any contact with signs or devices mounted on the walls or ceiling.
2. If desired, alternate raising each of the four extension posts up to three (3) notches at a time. Adjust the cart position if necessary. Raise the header until the top of the unit fits snugly against the ceiling. Do not over extend the header such that the ceiling grid is damaged. Make sure that the adjustable knobs of the extension rods are resting in the bottom of the notches.
3. Lock both casters by pressing the pedals on the casters down with your work shoe.
4. Supply power to the scrubber, turn the unit on, and adjust the variable speed control to the desired speed. Open the door and enter the unit. Be sure to close the door before beginning any work inside.
5. Open the side cover by using the two zippers. Roll up the side cover and store it with the two sets of hook and loop strips.

6. Secure the flanges to the wall.
7. When finished with the work, disconnect the flanges, and close the cover by using the two zippers.

Exiting

1. Decontaminate yourself and the inside of the mobile containment cart using a HEPA filter vacuum then exit the unit.
2. Completely lower the Upper Header of the unit by lowering each of the four extension posts up to three (3) notches at a time.
3. Turn off the scrubber, unplug the unit, and secure the cord.
4. Unlock both casters by lifting the pedal on the casters up with your work shoe.
5. Repeat procedure starting from *Setup* step 2, as needed.

DISASSEMBLING THE UNIT

Ensure all ABATEMENT TECHNOLOGIES® AIRE GUARDIAN® AG5000 Cart parts are decontaminated and dry before storage.

1. Remove the pull handle from the Exhaust Panel by removing the clevis and cotter pins and sliding the pull handle up to clear the holder, then down at an angle.
2. At each pole extension, apply steady, upward pressure to detach the extension from the pole plunger.
3. Set each post to the collapsed “C” position.
4. Remove the Upper Frame, loosen the thumbscrews, and retract each extension.
5. Remove the Fabric Enclosure.
6. Open the door and retract the Locking Channel for the Door Panel.
7. While leaving the Stiffener Rails in place, remove the Door Panel.
8. Set each post to the lowest notch and turn the knobs to the inside.
9. Retract the Locking Channel for one set of Side Panels and, while leaving the Stiffener Rail in place, remove one Side Panel or Side Access Panel.
10. Remove the Stiffener Rail and the second Side Panel or Side Access Panel.
11. Repeat steps 9 through 10 for the other side and the Exhaust Panel. Support the Exhaust Panel until it is removed from the Base Cart.
12. Set each post to the lowest notch and turn the knobs to the inside.
13. Tighten the thumbscrews of the Locking Channels in the retracted (inward) position.
14. Nest the panels in the Base Cart. The first Side Panel fits into the channel of the Base Cart with the bumpers facing up. The bumpers of the remaining panels nest into the previous panel’s bumpers. Stack the panels in the following order:
 - a. Four (4) Side Panels with the bumpers facing up.
 - b. Exhaust Panel with the posts facing up.
 - c. Door Panel with the posts facing down,
 - d. Place the Upper Frame on top of the Door Panel with the foam facing down.
 - e. Place the Fabric Enclosure inside the zipper of Top Cover.
 - f. Slide the Stiffener Rails into the cove of the Upper Header.
 - g. Place the Side Access Panel on top of the Upper Frame (if applicable).
 - h. Secure the panels to the cart with the supplied straps.

Note: Do not alter the stacking order.

Note: Do not overtighten the straps.

15. Attach the pull handle to the Base Cart with the provided clevis and cotter pins.

CARE OF THE UNIT

- Clean the AIRE GUARDIAN® AG5000 Cart with a mild water based cleaner or soap and water. Do not use hydrocarbon-based cleaners.
- Do not place items on the vinyl enclosure.
- Do not subject the vinyl enclosure to sharp or abrasive objects.
- Do not expose the vinyl enclosure to high heat.
- Be sure all metal components are properly secured during transport and in storage so they do not fall and cause personal injury or property damage.

Warning: Do Not Substitute. Use only ABATEMENT TECHNOLOGIES® Cart replacement parts. Substitute parts void the warranty, jeopardize worker and environmental safety, and adversely affect engineered performance levels.

AIRE GUARDIAN® AG5000 CART SPECIFICATIONS

FEATURE	SPECIFICATION
Weight with cart	230 lbs [104.3 kg]
Cart Footprint	32" W x 66.25" L [81.3 cm W x 168.3 cm L]
Collapsed header height	80" [203.2 cm]
Maximum extended header height	124" [315 cm]
Storage dimensions	32.5" W x 66.25" D x 20" H [82.6 cm W x 168.3 cm D x 50.8 cm H]
Header opening dimensions	36" L x 22" W [91.4 cm L x 55.9 cm W]
Optional Side Access opening	28" W x 62" H [71.1 cm W x 157.5 cm H]
Door	63" H x 27" W [160.0 cm H x 68.6 cm W] door opening; lockable handle.
Hardside polycarbonate UL94 flammability rating	V0
Lower panel construction	Anodized aluminum
Fabric enclosure	Fabric enclosure is removable and secured by hook and loop; includes two 12" x 12" clear windows that each act as a pass-through (window secured by hook and loop).
Top fabric	Top Cover is included with unit and secured by hook and loop.
Fabric fire retardant standard	ASTM-E84/NFPA701
Vinyl melting point	325°F
Exterior finish	Anodized aluminum
Header raising/lowering	Telescoping adjustable corner posts with 2.5" increments.
Casters	2 ea swivel, 2 ea. locking, non-marking rubber casters.
Foam Gasket on Header	1" wide x ¾" tall gasket around header perimeter to seal against ceiling.
Exhaust port	10" [25.4 cm] diameter exhaust located on back of unit.
Caddy cart	Optional caddy cart assembly that attaches to AG5000 Cart is available for locating the scrubber or HEPA vacuum external to the unit (P/N: AGCADDY).
Patents	US Patent Pending

LIMITED WARRANTY

Abatement Technologies (AT) warrants that goods sold to the original user shall be free from defects in material and workmanship for a period of 1 year, except such as are commercially acceptable. **AT does not warrant that the goods sold are merchantable or fit for any particular purpose. AT makes no warranties other than as stated in this paragraph. All other warranties, guaranties, or representations, express or implied, by operation of law or otherwise, are expressly disclaimed.** Goods found by AT to be defective or not to conform to specification shall upon return be replaced or repaired by AT without any additional charges, or, at AT's option, AT may refund the purchase price of such goods. AT will pay return transportation charges on returned goods not exceeding the transportation charges applicable to shipment from original destination unless the returned goods are free from defect and conform to specifications. Returned goods which are found by AT to be free from defect and to conform to specifications shall be held for Purchaser's shipping instructions, which instructions Purchaser shall furnish promptly upon request. **AT's liability shall in no event extend beyond replacement, repair or refund of the purchase price and AT shall not be liable under any circumstances for special, contingent or consequential damages, nor for loss, damages, or expenses directly or indirectly arising from the use of the goods, including without limitation, warehousing, labor, handling and service charges, die, equipment, or machine breakage, nor for costs, lost profits or loss of good will. The use of substitute, non-AT parts, in any AT product, voids all warranties and performance claims. The remedies set forth herein are exclusive.**

For warranty information and assistance contact ABATEMENT TECHNOLOGIES® Customer Service Department at +1 800 634 9091 (U.S.) or +1 905 871 4720 (Canada).